

FILTER OVERVIEW WITH SERVICE INTERVALS AND CAPACITIES

T670 Combine

ENGINE

[RE63932](#) (Tier III engine)
SECONDARY AIR FILTER, TIER 2 – [AH164063](#)
SECONDARY AIR FILTER, SHORT – [RE63932](#)
SECONDARY AIR FILTER, FINAL TIER 4 – [HXE11091](#)

Change secondary filter only with primary filter.

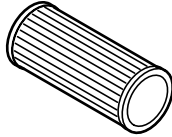

ENGINE

PRIMARY AIR FILTER, TIER 2 – [AH164062](#)
PRIMARY AIR FILTER, TIER 2 – [AH148880](#)
PRIMARY AIR FILTER, FINAL TIER 4 – [HXE11090](#)

Service filters only when engine air filter light stays ON or change as required.
 Note: Replace Secondary Filter also with Primary Filter.

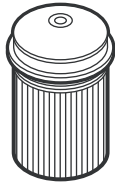

ENGINE COOLING FILTER

[DZ100304](#)

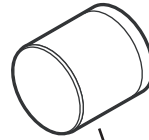

ENGINE GEARCASE FILTER

[AH128449](#)

Replace every 400 hours.



ENGINE OIL FILTER

[RE509672](#)

Replace every 250 hours or yearly. Fill Crankcase with seasonal viscosity grade oil or Torq-Gard Supreme™ (250 hours change interval). If using Plus-50 II™ oil and a John Deere filter, the service interval can be extended by 50 percent.

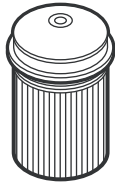

ENGINE FUEL FILTERS

PRIMARY FUEL FILTER (TIER 2) – [RE525523](#)
PRIMARY FUEL FILTER (FINAL TIER 4) – [RE539465](#)

FINAL FUEL FILTER (FINAL TIER 4) – [RE533910](#)

FUEL FILTER - STANDARD – [R502778](#)

Upto Engine Serial Number (- 096433)

FUEL FILTER - OPTIONAL – [N378886](#)

Upto Engine Serial Number (- 096433)

Replace fuel filters as required.

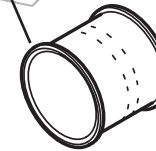

DIESEL PARTICULATE FILTER

[RE542183](#) (Final Tier 4/Stage V)

[DZ100174](#) From Engine Serial Number(102000 -)

[RE554498](#) From Engine Serial Number(102000 -)

Replace every 4500 hours or 3 years.

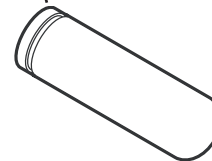

RECIRCULATION AIR FILTER

[L214634](#)

(MY '12 machines onwards)

[H220870](#)

(Prior to MY '12 machines)

Clean or replace every 200 hours or as required.

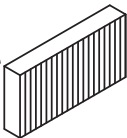

FRESH AIR FILTER

[RE284091](#) (MY '12 machines onwards)

[AH115833](#) (Prior to MY '12 machines)

Clean or replace after 50 hours or as required.

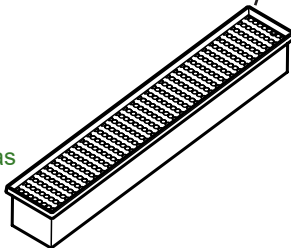

HYDROSTATIC PUMP / ENGINE GEARCASE / HYDRAULIC FILTER

OIL FILTER

[AH128449](#), [AXE43820](#) (only for machines not equipped with ProDrive™)

[AN207368](#), [AXE43821](#), [CE19990](#) (for machines with ProDrive™)

Replace after first 100 hours

Replace every 400 hours or yearly

Note: Replace all three filters at a time.

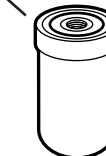
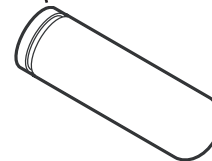

MAIN HYDRAULIC FILTER

[AL203061](#)

Replace every 400 hours.



JOHN DEERE
 Genuine Parts and Service

CAPACITIES

T670 Combine

CAPACITIES (Approximate):

Fuel Tank	800 L (210 gal)
Cooling System (with Heater).....	45 L (11.88 gal)
Engine Crankcase with Filter	29 L (7.66 gal)
3-Speed Transmission (Mechanical and PBST) ...	9.6 L (2.53 gal)
3-Speed Transmission (ProDrive™).....	13 L (3.43 gal)
Feeder House Reverser Gear Case.....	2.0 L (0.53 gal)
Countershaft Drive Gear Case	1.2 L (0.32 gal)
Cylinder Drive Reduction Gear.....	1.2 L (0.32 gal)
Engine Gear Case (for machines w/o ProDrive™)...	16 L (4.22 gal)
Engine Gear Case (for machines with ProDrive™)	20 L (5.28 gal)
Hydrostatic/Hydraulic Oil Reservoir.....	45 L (11.88 gal)
Loading Auger Gear Case on Clean Grain Elevator	3 L (0.79 gal)
Stripper Reverser Gearcase.....	0.4 L (0.11 gal)

Final drives (10-bolts wheel rim type—each)	7.0 L (1.85 gal)
Final drives (20-bolts wheel rim type—each)	25 L (6.60 gal)
Diesel Exhaust Fluid (DEF) Tank.....	32 L (8.45 gal)
Overshot Beater Gearcase	0.9 L (0.24 gal)
Rear Axle differential (powered axle only).....	24.5 L (6.47 gal)
Rear Axle reduction (powered axle only).....	0.7 L (0.19 gal)
Rear Axle wheel hub (non-powered axle only).....	0.5 L (0.13 gal)
Water Tank (if equipped).....	10 L (2.64 gal)

[Return to Filter Overview](#)